

MA500

Metal Design & Anti-Vandal IP65 Outdoor Fingerprint Access Control



MA500 is an advanced biometric access control terminal that can be operated in standalone mode as well as network mode through TCP/IP or RS485 for software management. Equipping with a robust metal housing and durable backlit keypad, MA500 is vandal resistant and IP65 rated. It is suitable to be installed in high traffic and harsh environments.

Apart from connecting with electric lock, door sensor, alarm and exit button, MA500 can perform as a Wiegand fingerprint reader by any 3rd party control panels, namely, the network mode. It is value added and very easy to replace conventional proximity or keypad access control system by biometric technology.

Embedded with the latest firmware, MA500 supports ZKAccess3.5 management software which has versatile features and powerful functions. Another benefit is that, it supports FR1200 fingerprint reader and realizes Master and Slave solution by RS485 connection instead of Wiegand. MA500 can also function the same as FR1200 to connect with inBIO series controllers as a RS485 fingerprint reader.

Feature

- Vandal resistant & IP65 waterproofed, Ideal for outdoor installation
- Large storage capacity up to 3,000 fingerprints, 30,000 proximity cards and 100,000 logs
- Able to connect specially designed FR1200 fingerprint slave reader
- Combine master and slave system to secure the entrance and exit with dual biometric authentication and by RS485
- Support Anti-passback to maximize security level
- Easy to integrate with existing system. Wiegand output is connectable to most of the access control panel brands
- Provide various types of alarms, such as, door sensor alarm, duress alarm etc
- Free Pull SDK available for integration

Specifications

Model	MA500
Software	ZKAccess3.5
SDK	New PULL SDK
Fingerprint Sensor	Optical sensor with protective cover
Algorithm Version	ZKFinger V10.0
Fingerprint Capacity	3,000
Card Capacity	30,000
Log Capacity	100,000
RF Card	EM(standard)/Mifare(optional)
Authentication Method	FP only, RF only, PIN only, FP/RF/PIN, PIN&FP, PIN & RF
Access Control Interface	Electric lock, Door sensor, Alarm, Exit button
Communication	TCP/IP, RS485
Wiegand Signal	Wiegand out
Ingress Protection Rate	IP65
Power Supply	12VDC 3A
Operating Temperature	°0C - °45C
Dimensions (WxHxD)	83mmx127.5mmx74mm

Configuration

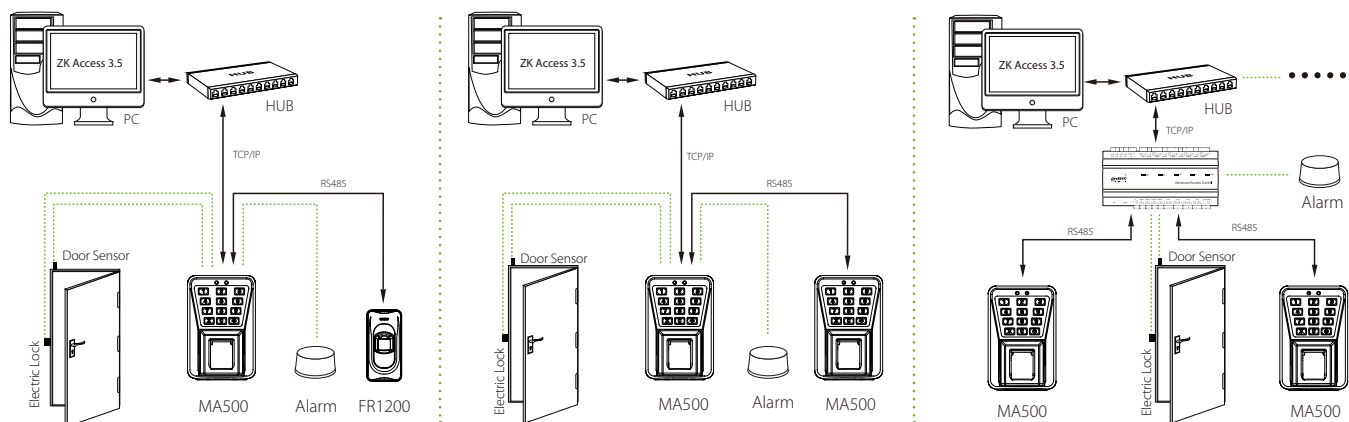

ZKTeco Inc.

ZK Mansion, Wuhe Rd, Gangtou, Bantian, Buji Town,
Longgang District, Shenzhen China 518129
Tel: 48/47/46/2345 8960-755-86
E-mail: sales@zkteco.com
www.zkteco.com

Global Offices:

USA: + 6007-412-732 1
EU: 916532891 34+
Brazil: 8326-2515 31 55+
Thailand: 027199154-66+
Mexico: 52928418-55-52+

South Africa: 1047 259 12 27+
Egypt: 201110444134+
Dubai: 310 6091 4 971+
India: 8123536788 91+
Indonesia: 8949 2921 21 62+

Vietnam : 5813007-0169-84+
Philippines: 9084118832 63+
Russia: 81-46-178 915 8+